

Fixing Instructions

Please read carefully before commencing

Note: Before bending this pole, read point 2 carefully

We recommend 2 persons undertake the fixing of this pole.

If fitting with a Return Kit, please open and read both sets of fixing instructions before installation

How the Completed Pole should look

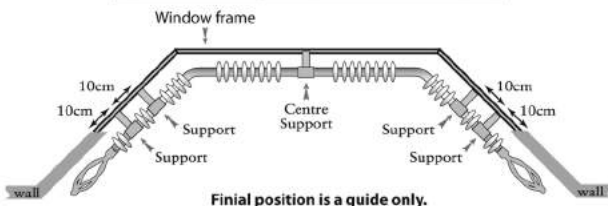

1



Gently bend the poles to the desired shape.

ENSURE THE CUTS IN THE POLE ARE TO THE INSIDE OF THE BEND.

Please Note: Bending the product the wrong way will cause irreparable damage.

Practical Tip: Use your knee to ease the bending process and generate a smooth bend being careful to avoid injury or damaging your clothes.

2

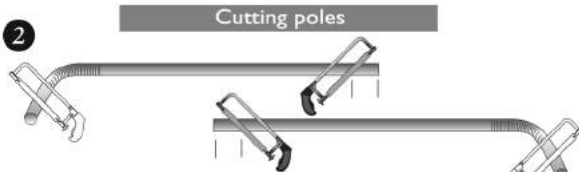

Cut an equal amount off both poles. **Remember to leave 10cms beyond the last support.** Note: You may need to cut both ends of both poles.

Mark & Drill Supports

3a



3b

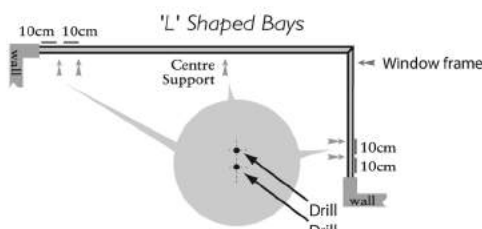

3c

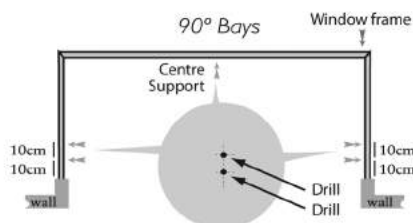

Mark and drill the positions, (using a 6mm drill bit), for the 5 supports as shown by arrows in the illustration that best matches your window.

Ensure the Centre Support is positioned in the middle of the window.

Insert the wall plugs supplied. **For ceiling fix, mark and drill holes in the ceiling.**



4

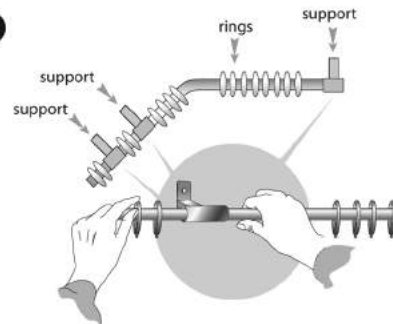

Slide 1 ring for every 10cms of pole and 2 supports onto both poles and one in the centre as diagram above shows, ensuring 2 rings are placed between the two end supports. 1-2 rings should also be allocated for the space between the end support and the finial. Allow the supports to hang loosely from the pole at this stage.

5

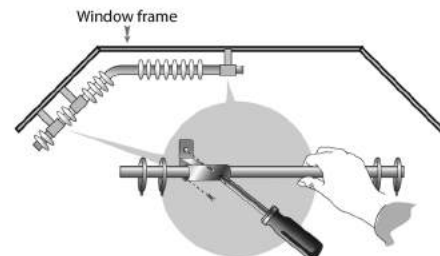

5. Whilst 1 person holds the pole in position, the other person should securely fix the complete set in place to the holes drilled in Step 1.

6

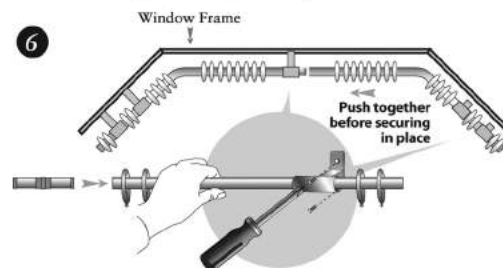

Insert the joining splice into the second pole again, using 2 persons push the 2 poles together before securely fixing to the wall or ceiling.

7

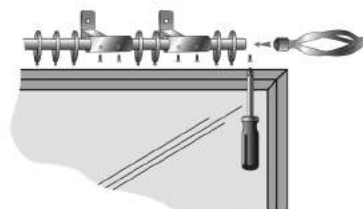

Tighten the grub screws in the supports to hold the pole in place and push on the finials, ensuring 1 or 2 rings are between each end support and finial, these will act as an end stops.

Please Note: Component parts may vary in style.